

PROVOX[®] Vega[™] Puncture Set

  Provox Vega Puncture Set

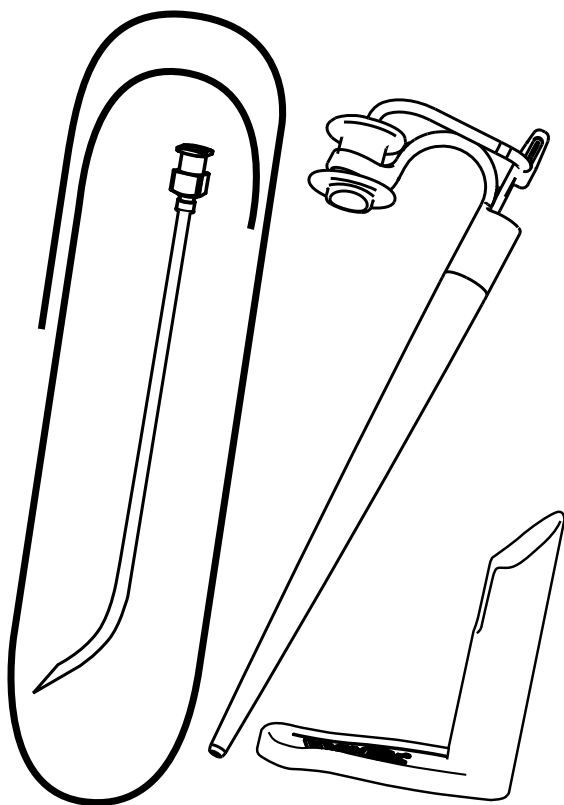

MD

Rx
ONLY



CE 0413



STERILE EO



42°C
108°F
2°C
36°F
FRT

1. Provox Vega Puncture Set

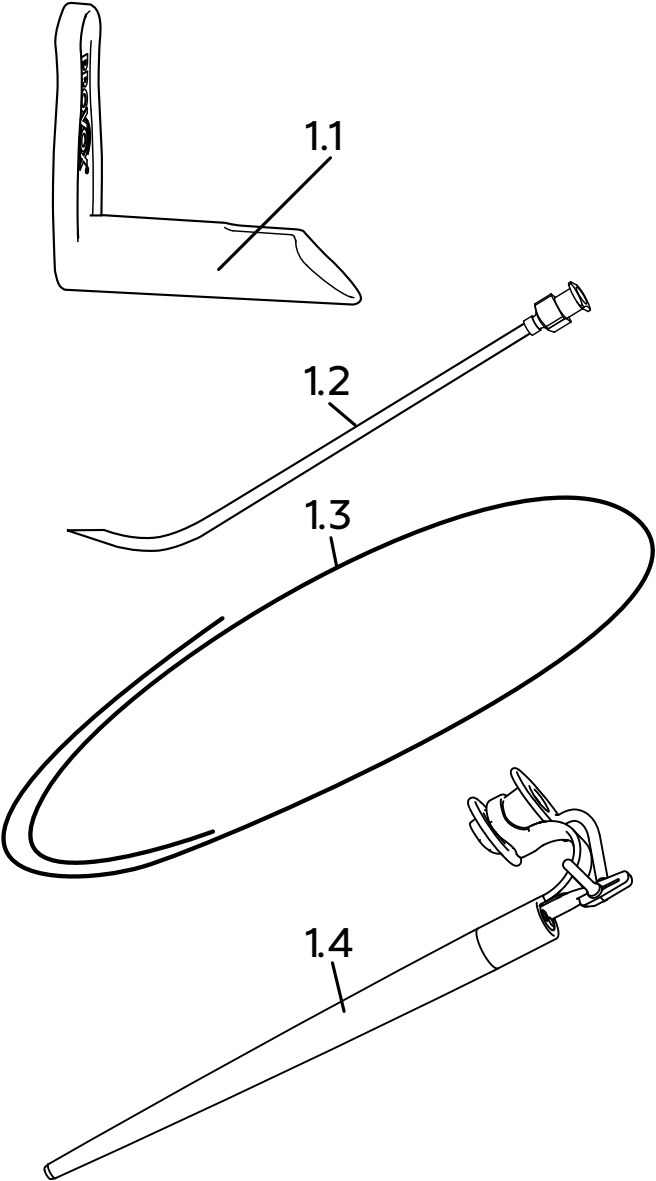

1. Provox Vega Puncture Set

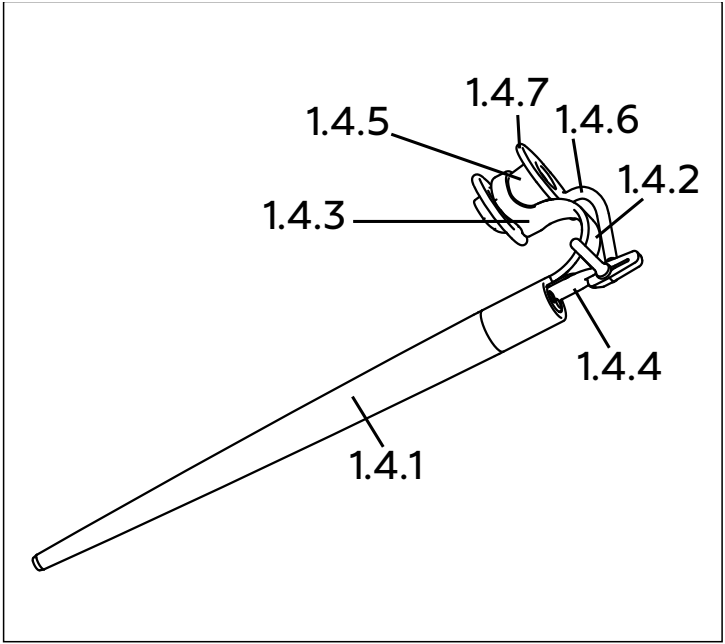

2. Primary Puncture and Prosthesis placement

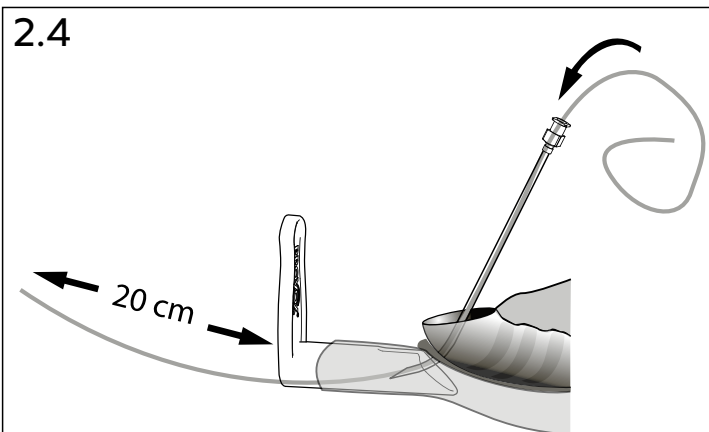
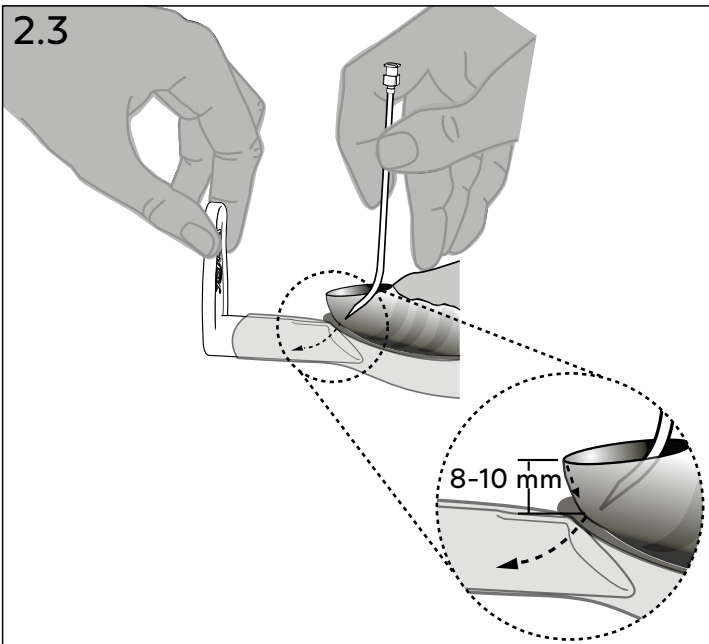
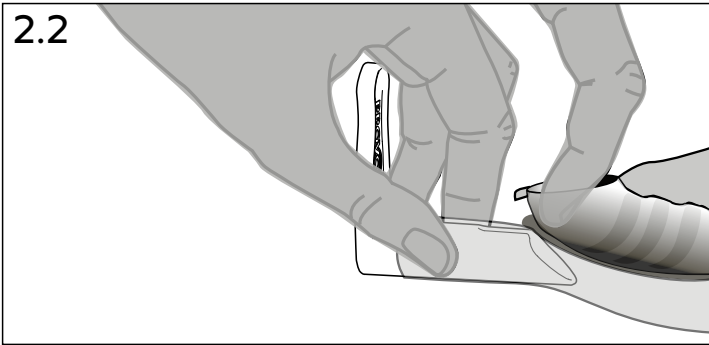
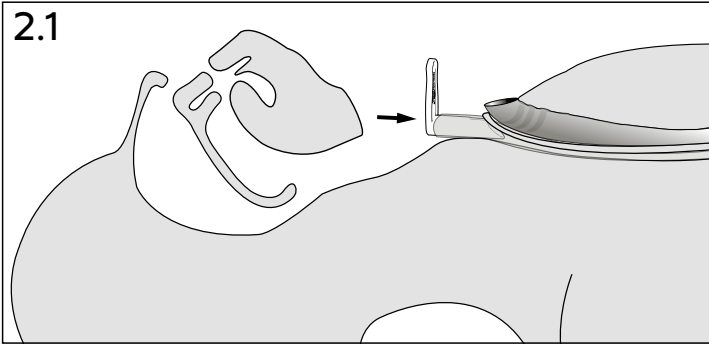

2. Primary Puncture and Prosthesis placement

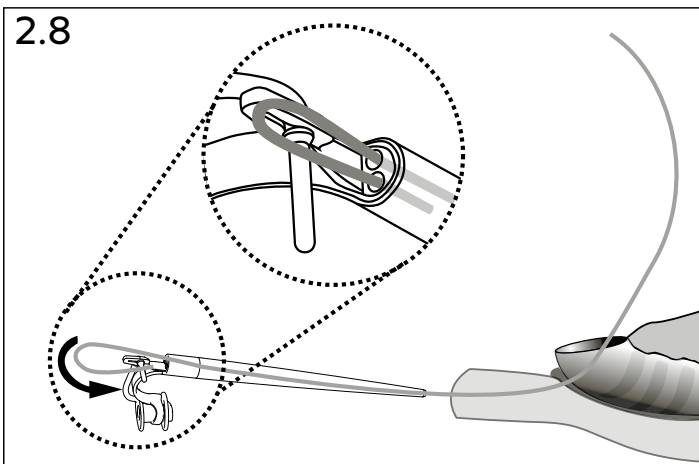
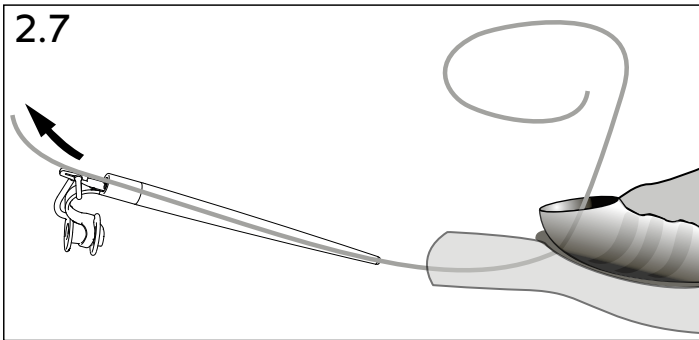
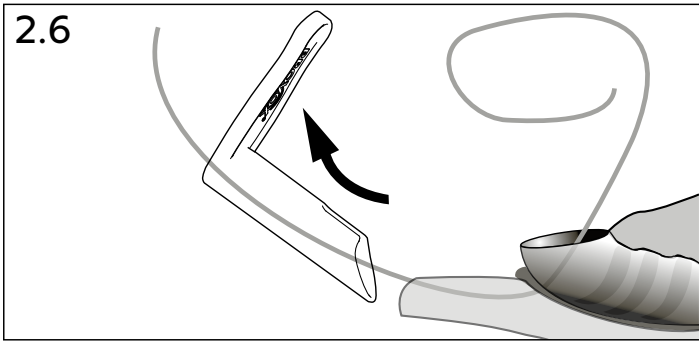
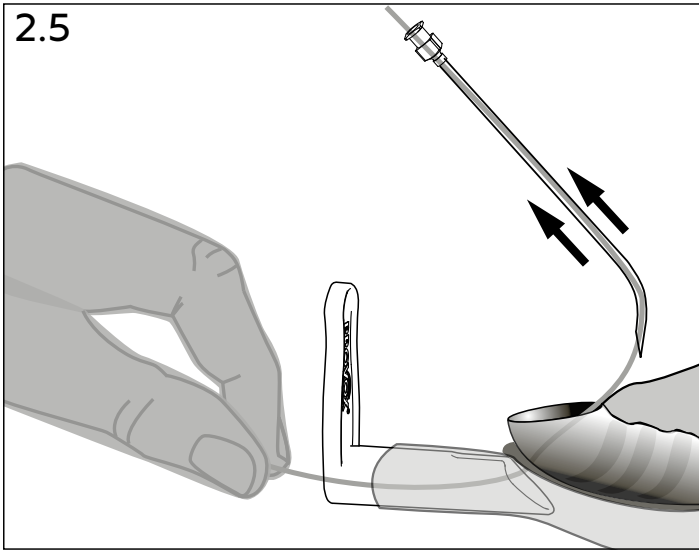

2. Primary Puncture and Prosthesis placement

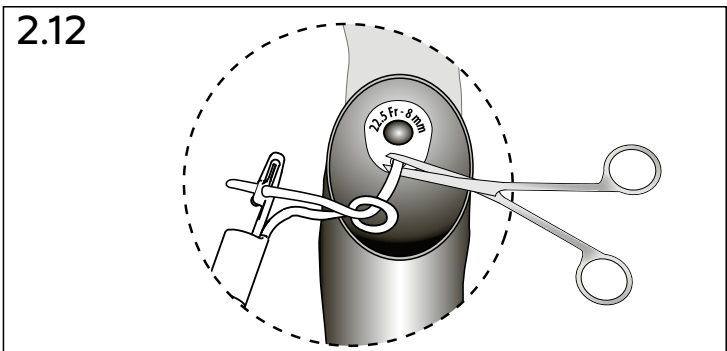
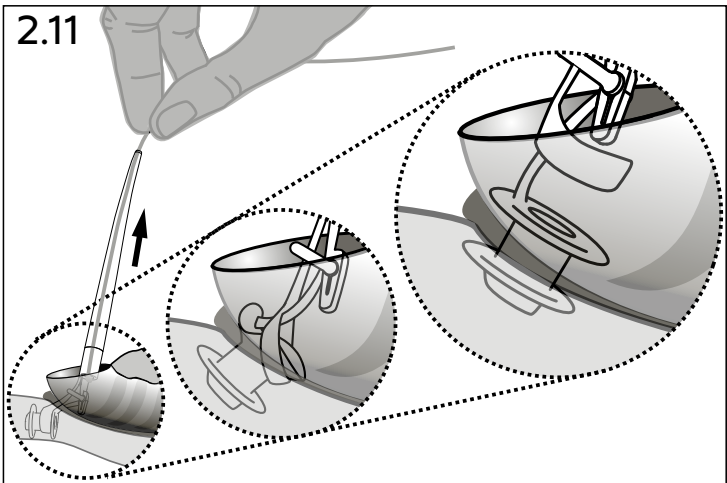
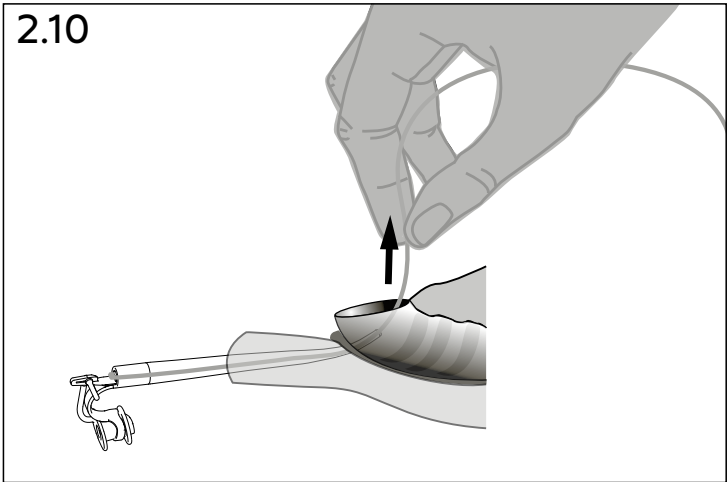
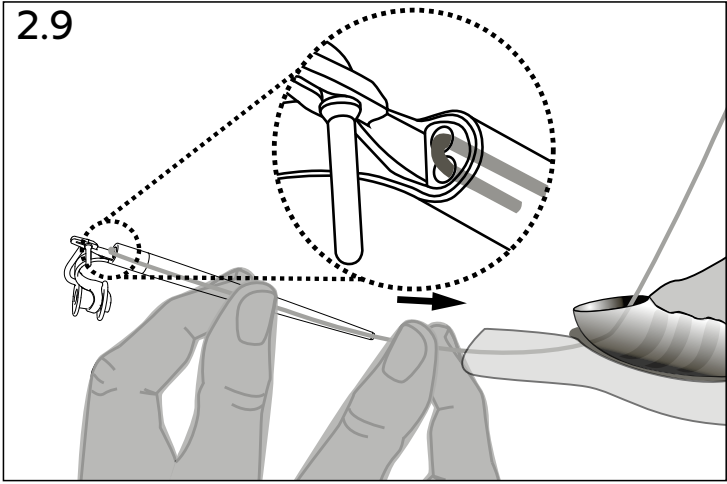

3. Secondary Puncture and Prosthesis placement

3.1

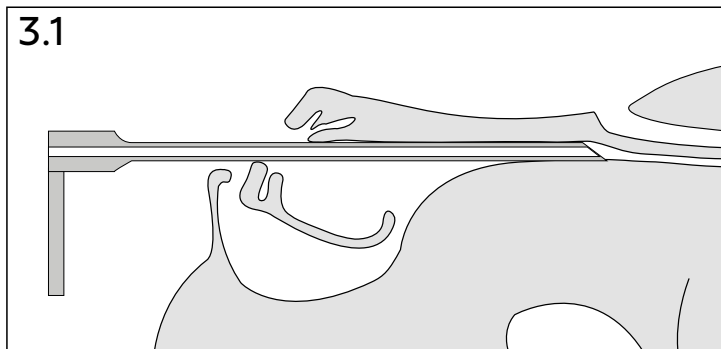

3.2

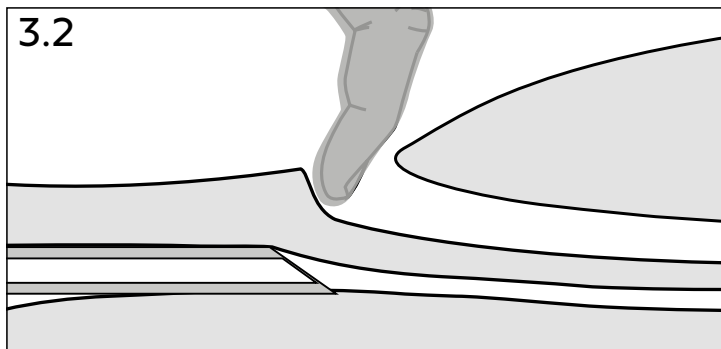

3.3

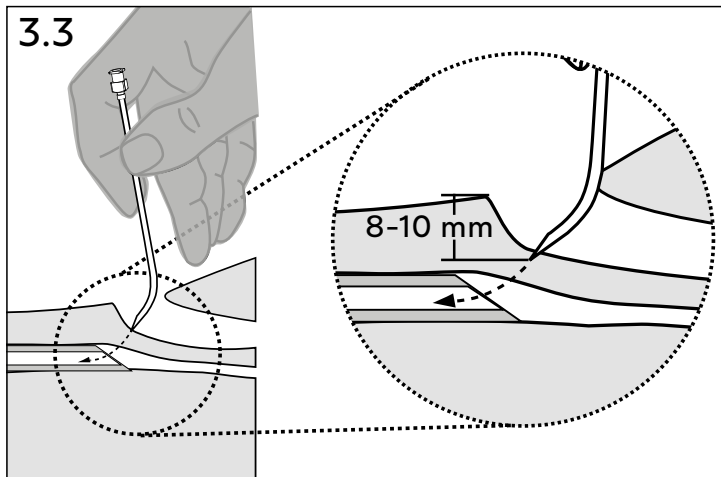

3.4

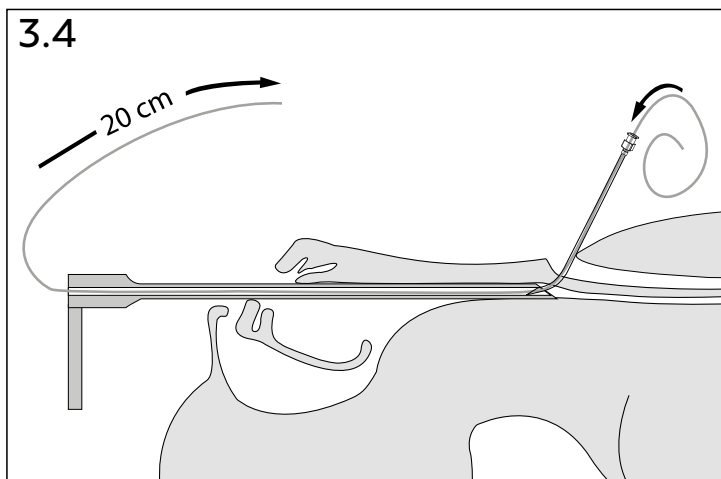

3. Secondary Puncture and Prosthesis placement

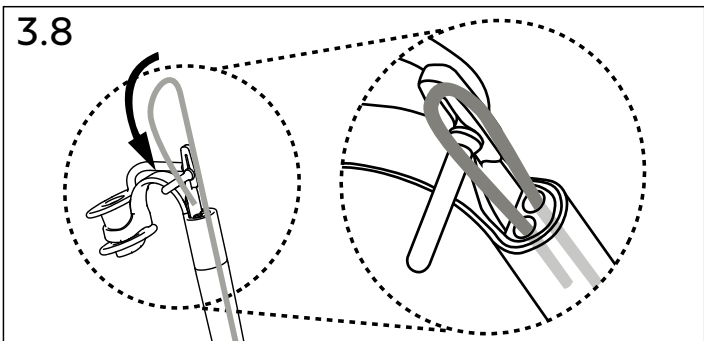
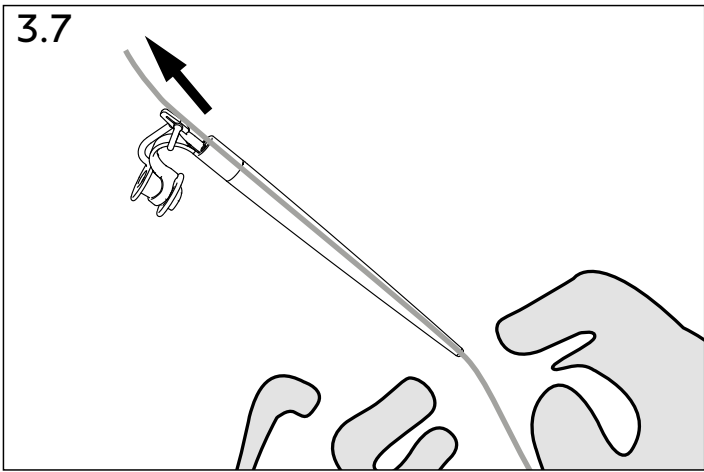
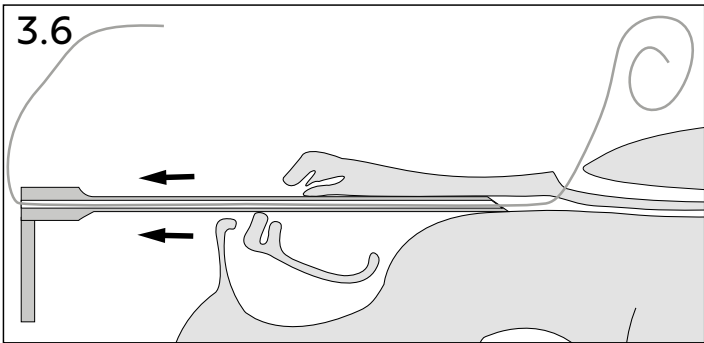
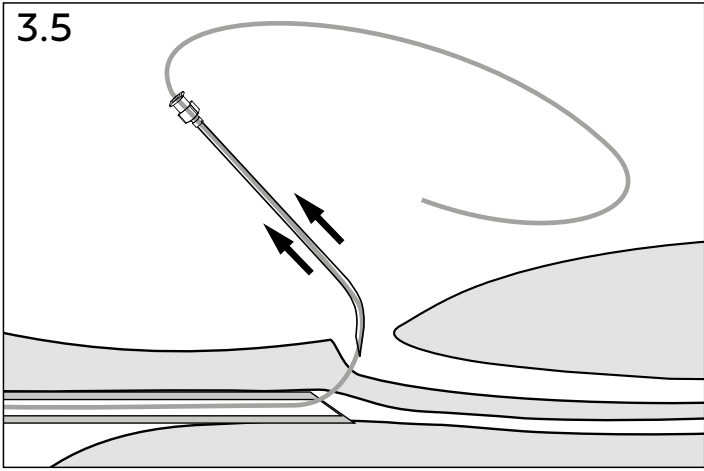

3. Secondary Puncture and Prosthesis placement

3.9

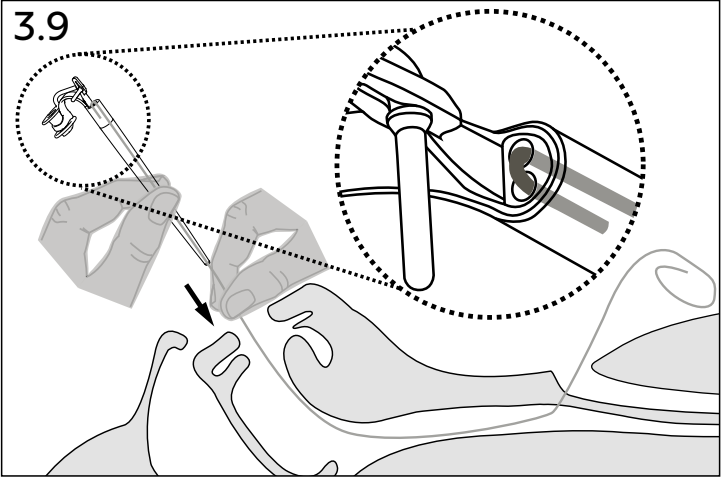

3.10

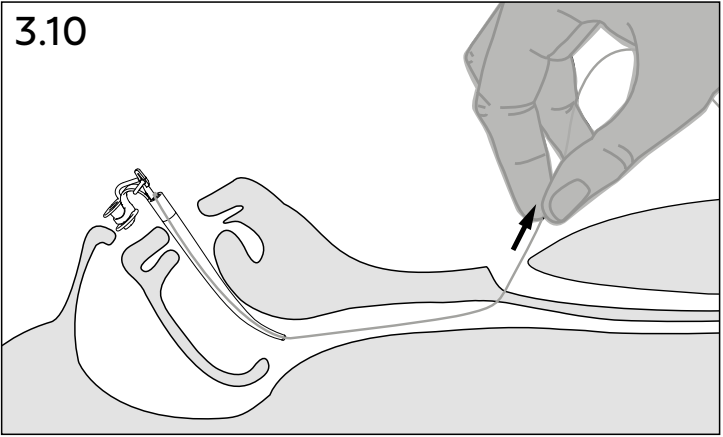

3.11

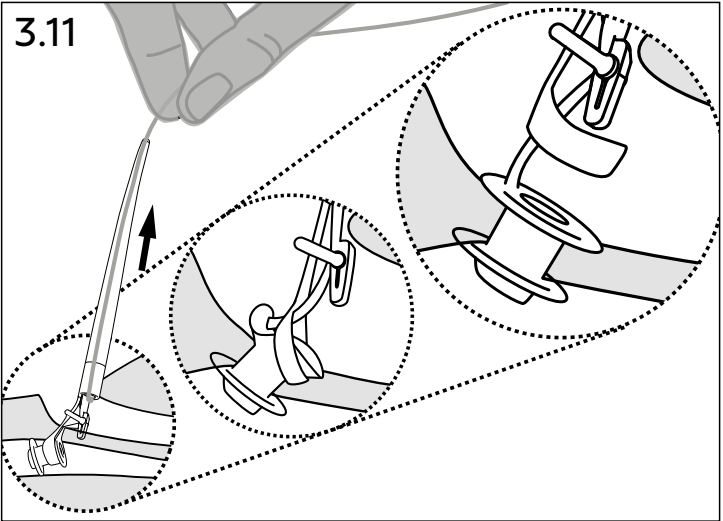

3.12

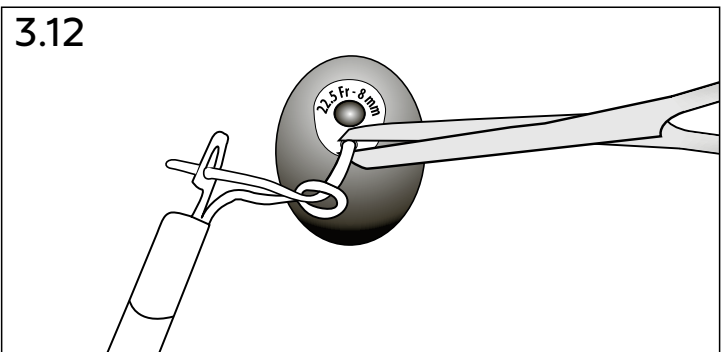

4. Reload of the Puncture Set

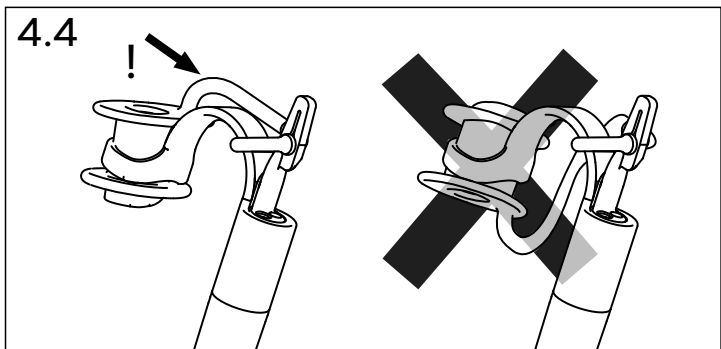
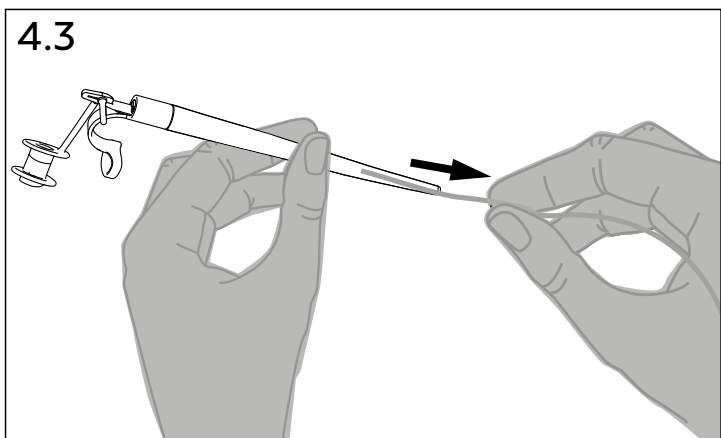
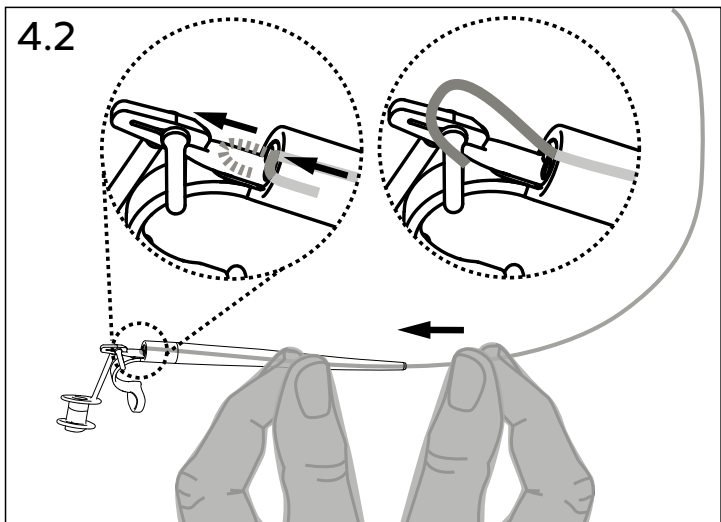
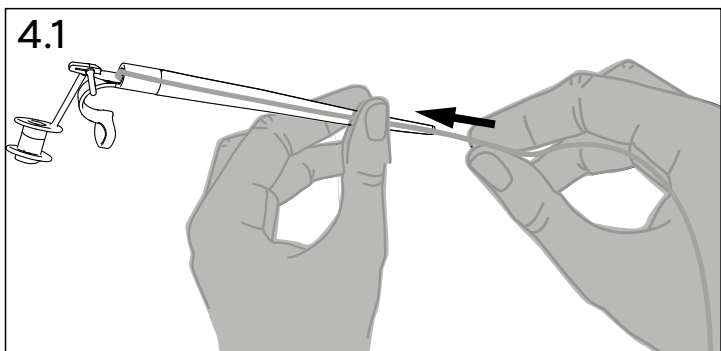



No. 10647, 2022-03-08

Atos
atosmedical.com



Atos Medical AB
Kraftgatan 8, SE-242 35 Hörby, Sweden
Tel: +46 (0)415 198 00 • info@atosmedical.com